



DIAMONDBACK

DiamondBackCovers.com / 800 935 4002

BED RAIL CAP SHIMS

2019-UP

GMC SIERRA / CHEVY SILVERADO

INSTALLATION GUIDE

MISC-24

 **15 minutes**
Normal install time

Keep an eye out for these icons:

 **IMPORTANT!**
Important installation information

 **Helpful Hints**
Tips to assist installation

PARTS INCLUDED:



8 Pack of shims

TOOLS REQUIRED:



Rubbing Alcohol



Lint-Free Cloth



Scissors



PRE-INSTALLATION NOTE:

To ensure the adhesive on the shims adheres properly, make sure the temperature of the cleaned surface is at least 50°F and will remain so for at least a day.





50°F min.

REMOVE THE BED RAIL CAPS

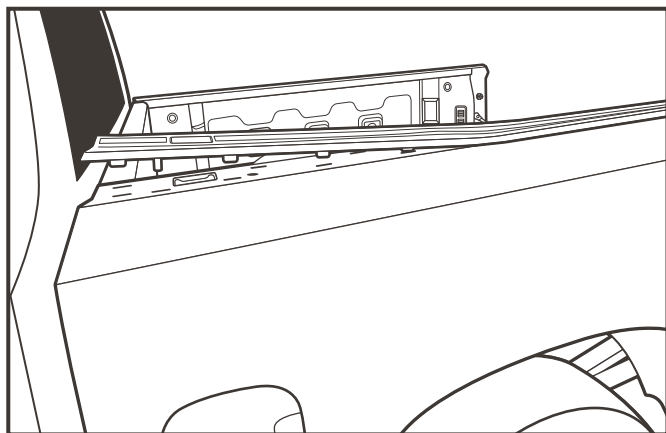
-  To remove the bed rail cap, start at the front of the bed near the cab on either side.
-  Be careful not to bend or crease the bed rail cap. Stay as close to the clip that you are trying to release as possible.
-  Using your fingers, grasp under the bed rail cap and pull directly up. Multiple clips may be released at one time during this process.



-  Continue using upward force as you work away from the cab, clips will continue to release.
-  Continue working towards the tail of the truck until you have completely removed one of the bed rail caps from the truck.
-  Repeat steps 1-4 on the other side.

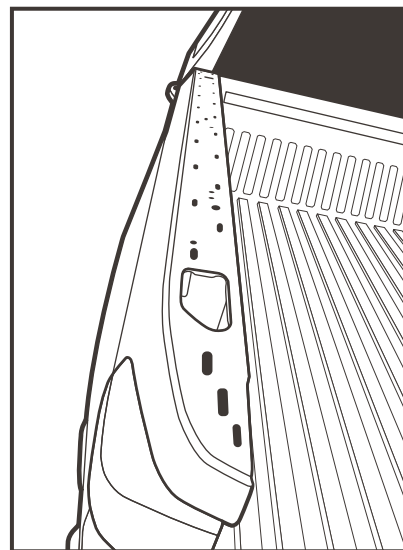

CONTINUED ON REVERSE >

INSTALL THE SHIMS

- 6** You will need to clean the underside of the bed rail caps. We recommend alcohol and a lint free cloth to remove any contaminants or dirt. Allow them to dry.
- 7** Each bed rail cap will require 4 shims. Using the illustration as a guide, test fit the shims in the shown locations on the underside of the bed rail caps. They will all be towards the inside of the bed rail cap.
- ★ During placement it can be helpful to set the shims with the adhesive backing up to confirm placement before removing tape.
- 8** Peel and place the shims at the locations determined during the previous step. Be sure to press firmly along the entire shim to ensure adhesion.

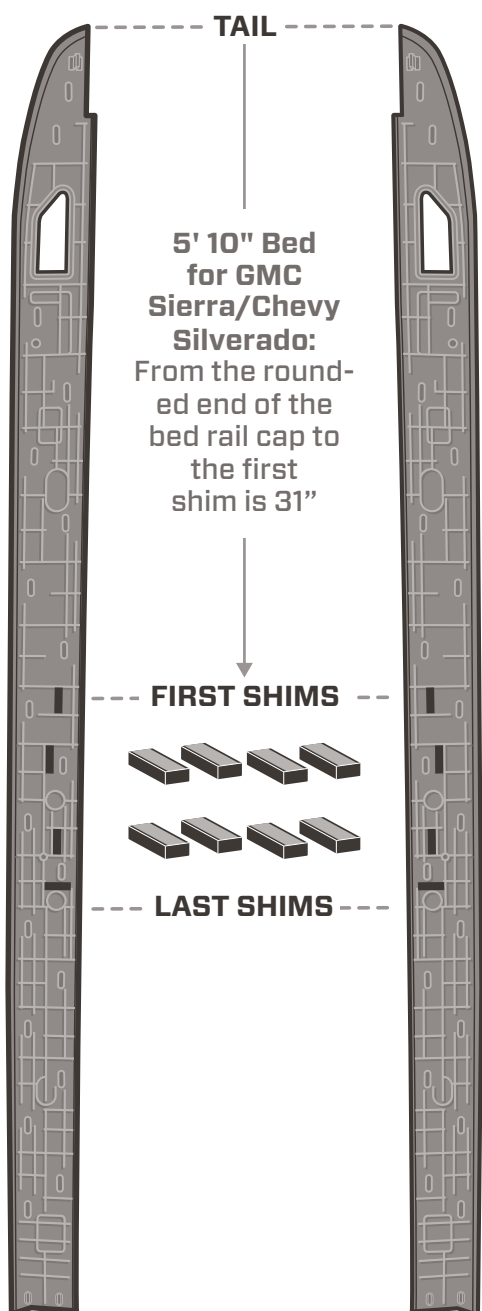

- 9** Install the bed rail cap by starting at the cab. Make sure the clips and locating pins are aligned and begin pressing them back into the slots by applying downward pressure and working towards the tailgate.
- ! Be sure to check the alignment of the rear locating pin before snapping it into place.
- 10** Repeat this process on the other side.

This completes the bed rail cap shim installation for the GMC Sierra / Chevy Silverado.

Please continue with the Bulkhead Prep Kit before starting the installation of your DiamondBack cover.

