

# START HERE!

## READ ME FIRST

Don't be a hero and muscle through this installation without reading these fitting instructions first! Improper installation of this gear may void certain aspects of your warranty.

Before you begin, take a moment and open all your Front Runner rack kit boxes and gather the assembly instructions for the various components.

A complete kit will contain:

1. A Front Runner Track Kit
2. A Front Runner Load Bar Kit

This document will guide you through the assembly of the mounting system and assist you in fitting the roof rack tray or load bars to your specific vehicle.

Please refer to the next page for a list of all the components, quantities and tools required.

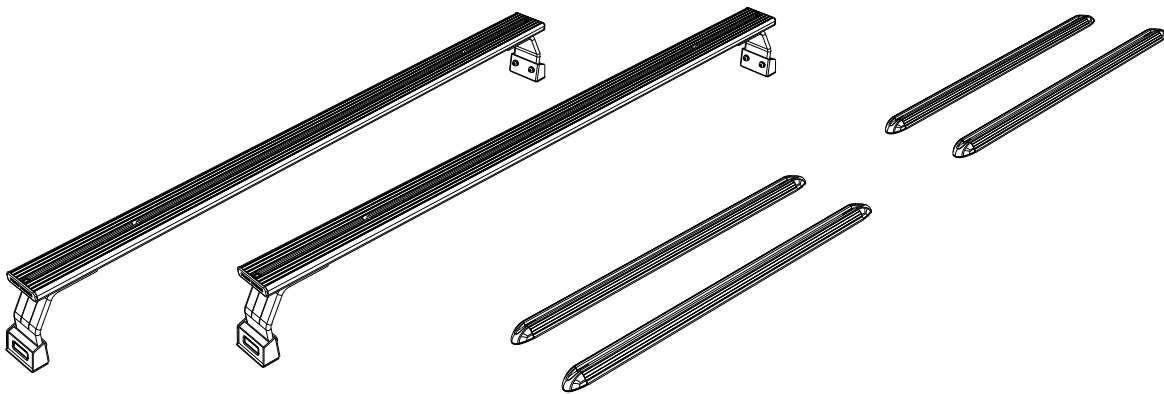

### IMPORTANT WARNING!

IT IS CRITICAL THAT ALL FRONT RUNNER PRODUCTS BE PROPERLY AND SECURELY ASSEMBLED AND ATTACHED TO YOUR VEHICLE. IMPROPER ATTACHMENT COULD RESULT IN AN AUTOMOBILE ACCIDENT, AND COULD CAUSE SERIOUS BODILY INJURY OR DEATH. YOU ARE RESPONSIBLE FOR ASSEMBLING AND SECURING ALL FRONT RUNNER PRODUCTS TO YOUR VEHICLE, CHECKING THE ATTACHMENTS PRIOR TO USE, AND PERIODICALLY INSPECTING THE PRODUCTS FOR ADJUSTMENT, WEAR AND DAMAGE. THEREFORE, YOU MUST READ AND UNDERSTAND ALL OF THE INSTRUCTIONS AND PRECAUTIONS SUPPLIED WITH YOUR FRONT RUNNER PRODUCT PRIOR TO INSTALLATION OR USE. IF YOU DO NOT UNDERSTAND ALL OF THE INSTRUCTIONS AND CAUTIONS, OR IF YOU HAVE NO MECHANICAL EXPERIENCE AND ARE NOT THOROUGHLY FAMILIAR WITH THE INSTALLATION PROCEDURES, YOU SHOULD HAVE THE PRODUCT INSTALLED BY A PROFESSIONAL INSTALLER OR OTHER QUALIFIED PERSONNEL.

**NOTE:** Front Runner will not be responsible for any damage caused by the failure to install the product according to these instructions.

Please call us if you have any questions about the installation of this product.

# 1 GET ORGANIZED - TRACK

## IN THE BOX

1	4 X	Track - 555mm Long
2	1 X	Track Rubber - 2750mm Long
3	8 X	Track End Cap
4	20 X	M6 x 30 Button Head Bolt
5	20 X	M6 x 19 x 1 SS Flat Washer
6	20 X	M6 Nyloc Nut
7	12 X	M6 Jack Nut
8	1 X	Installer Wrench

## TOOLS NEEDED

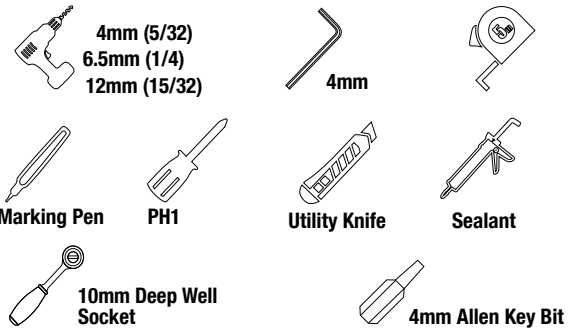
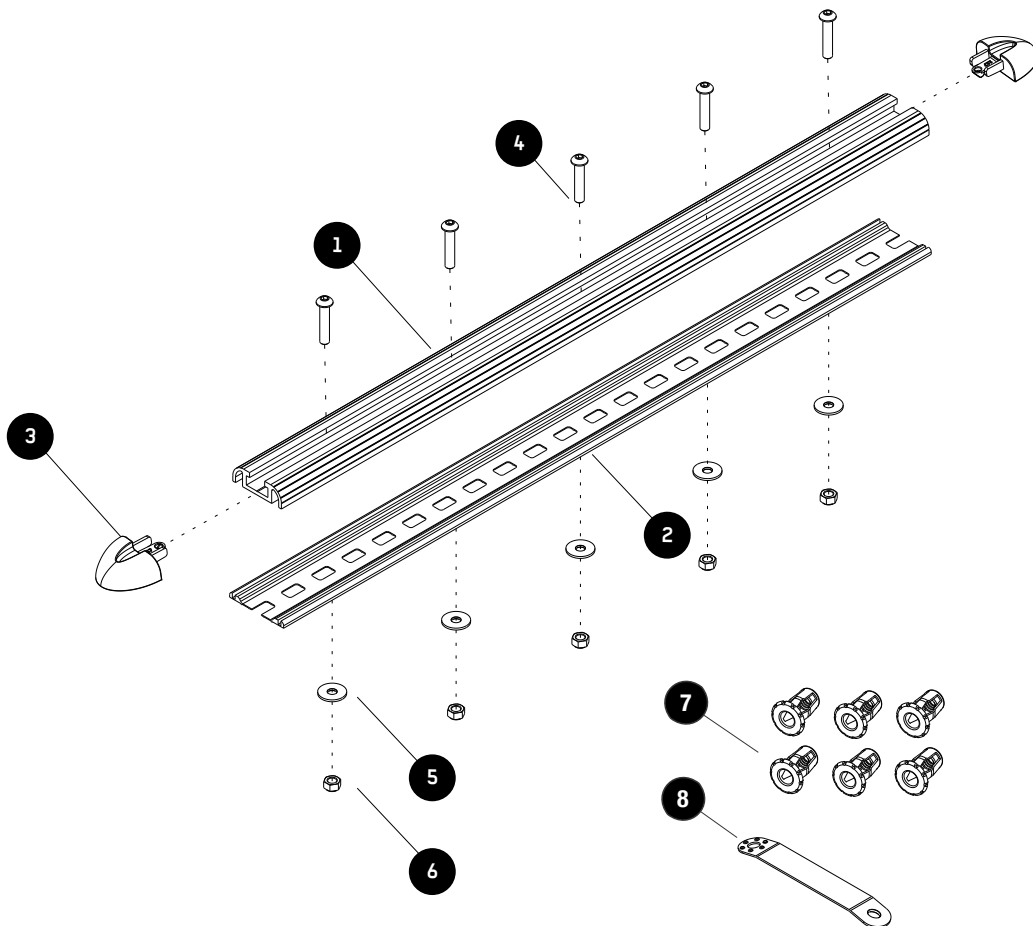

FIGURE 1.1



**NOTE: A minimum of 3 screws per track must be used when securing tracks.**

1

# GET ORGANIZED - RACK

## IN THE BOX

1	8 X	M8 x 20 T-Bolt
2	4 X	Cover Plate
3	4 X	Leg Base
4	8 X	M8 x 30 Button Head
5	8 X	M8 x 19 x 2SS Flat Washer
6	16 X	M8 Nut Cap
7	24 X	M8 Nyloc Nut
8	4 X	Leg
9	8 X	M8 x 25 Hex Bolt
10	2 X	Slat - 1475mm Long
11	4 X	Slat End Cap

## TOOLS NEEDED



FIGURE 1.2

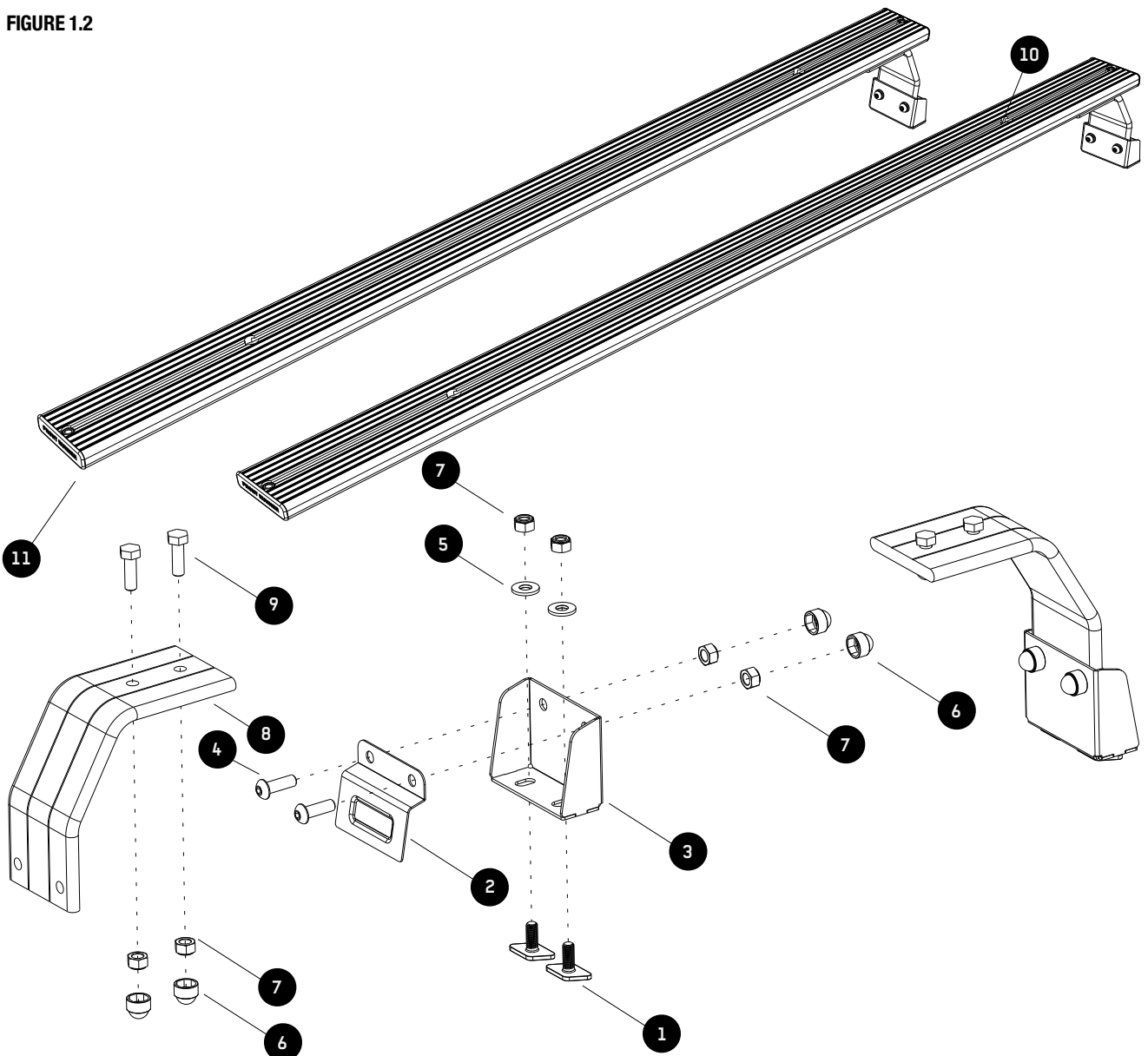

## 2

### FIT AND SECURE TRACKS



Some DiamondBack covers have factory etch marks beneath the cover indicating ideal positioning for tracks. You will see a -O- mark with a -F- beside it.

2.1

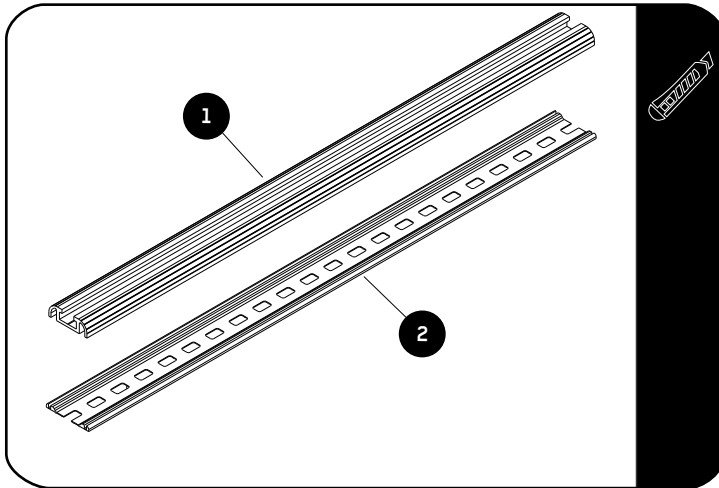

For best fitment results, it's recommended to verify placement of the tracks, legs, and load bars on the DiamondBack cover before drilling.



Remove the double sided tape from the bottom of the track.

Starting on one end, feed the Track Rubber (Item 2) onto the Track (Item 1). Press the rubber onto the track to insure adhesion. Trim the Track Rubber to the correct length.

Do this on the remaining 3 Tracks.

2.2

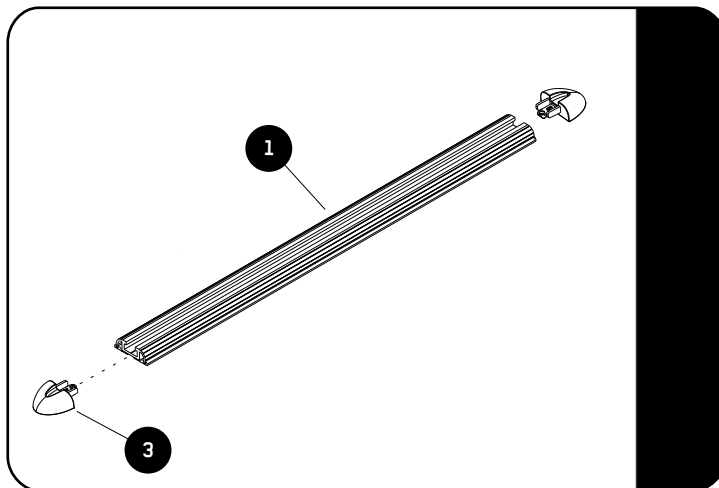

Insert endcaps (Item 3) on the track ends.

2.3

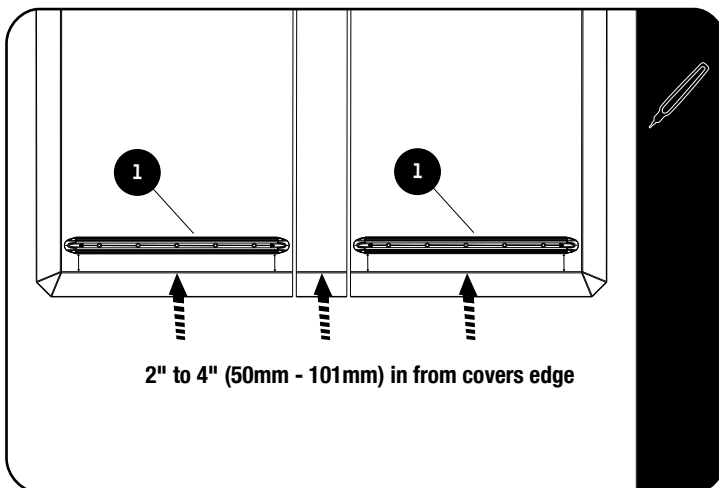

2" to 4" (50mm - 101mm) in from covers edge



Position the Tracks (Item 1) on each panel of the DiamondBack cover as shown.

Keep the tracks parallel and do NOT follow the taper of the cover. Tracks should be 2-4" (50-101mm) in from the cover's edge and 58" (1475mm) max width apart left to right.

Mark the pre drilled holes in the track onto the cover.



Due to the position of components below, using all 3 of the middle holes may not be possible. At least one of the three mid mounting holes must be used together with the two outer holes.

Double check the underside of the cover to verify the marked hole positions are free from any obstructions for the fasteners incl the drill bit hitting your bed rails. Some covers have "F" etch marks designated on the underside for positioning.



Should a marked hole be inaccessible use the jack nuts supplied.

2.4

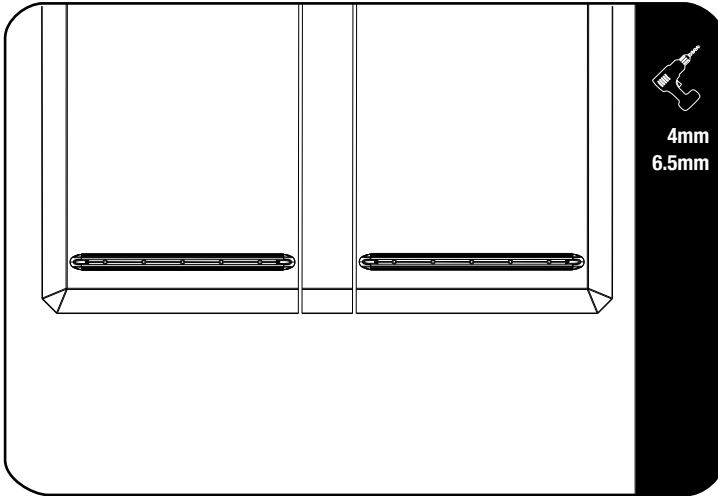

Remove the Tracks and drill a 4mm pilot hole on each of the marks you have made. Open the holes to 6.5mm.

2.5

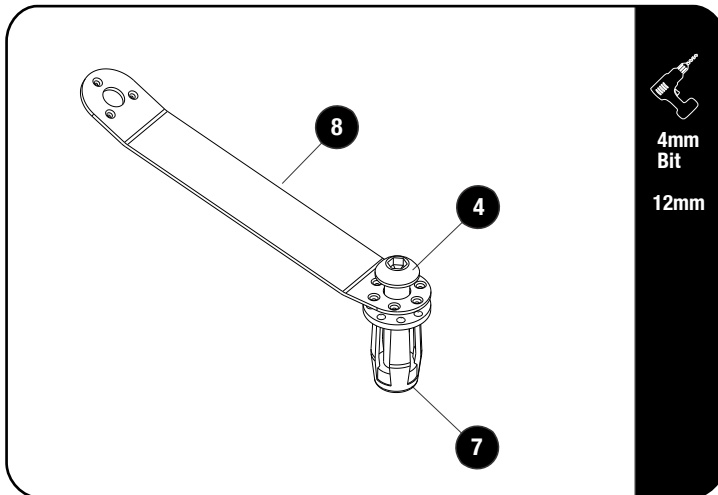

Open any inaccessible holes where a jack nut will be used to 12mm.

Insert an M6 x 30 Button Head Bolt (Item 4) into the one side of the Installer Wrench (Item 8).

Loosely tighten a Jack Nut (Item 7) onto the Button Head Bolt as shown.

Place the assembly into one of the holes drilled in 2.3. Using a Drill and a 4mm Allen Key Bit, set the Jack Nut into the hole while holding the Installer Wrench firmly.

Make sure that the Jack Nut has pulled up all the way to the underside of the panel.

2.6

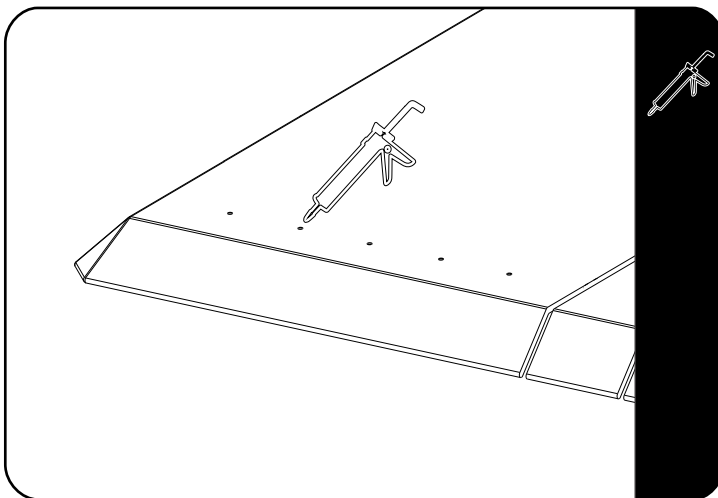

Before fitting the Tracks, place a small bead of sealant around each hole.

2

**FIT AND SECURE TRACKS**

2.7

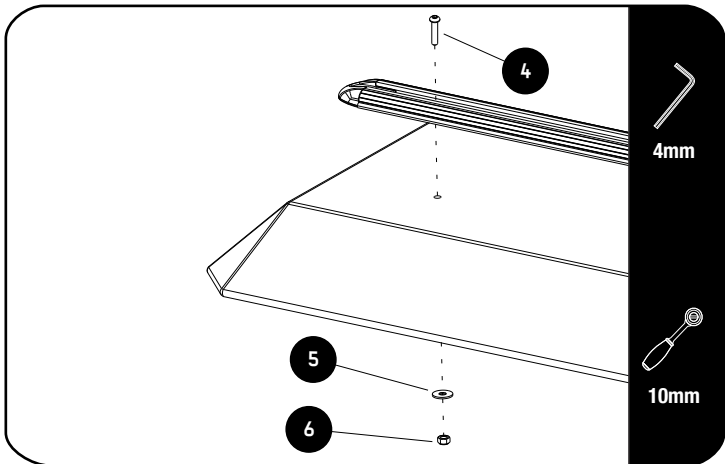

Secure the Tracks to the Cover using M6 x 30 Button Head Bolts, M6 x 19 x 1SS Flat Washers and M6 Nyloc Nuts (Items 4, 5 & 6) as shown.

3

**FIT AND SECURE FEET AND LOAD BAR**

3.1

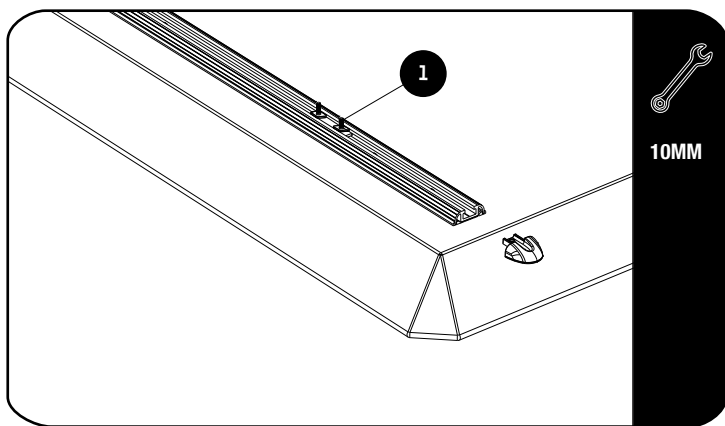

Refer to Figure 1.2 for fitment.

To fit your Front Runner load bars, remove the End Caps from one side Track.  
Slide the M8 T-Bolts (Item 1) into the Track and reattach the End Caps.

3.2

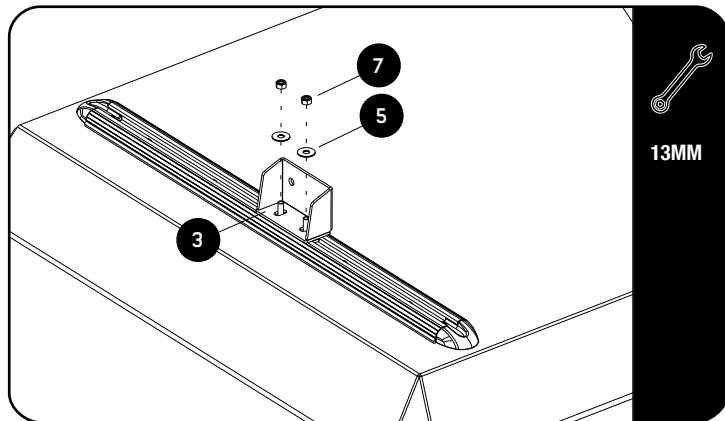

Fit a Leg Base (Item 3) to the M8 T bolts using M8x25x2 Flat Washers and M8 Nyloc Nuts.

Position the Leg Base along the track and align the opposite side Leg Base at the same distance along the Track. Fully tighten the Leg Base to the Tracks

### 3

## FIT AND SECURE FEET AND LOAD BAR

3.3

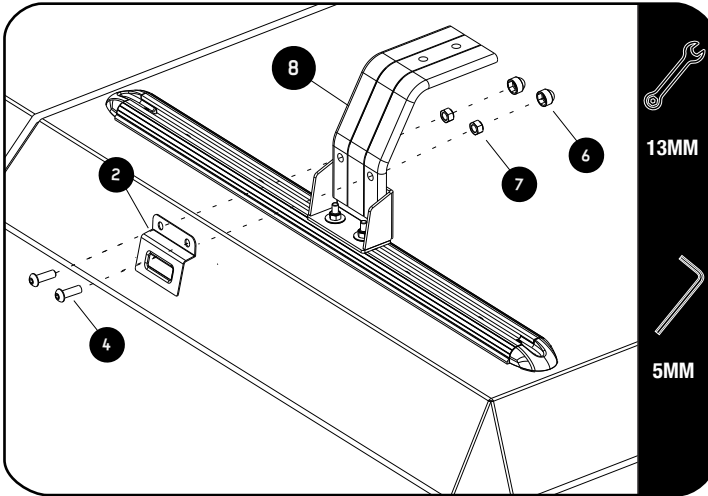

Assemble the Legs (Item 8) to the Leg Base (Item 3) by using M8 x 30 Button Heads & M8 Nyloc Nuts (Items 4 & 7) and the Cover Plate (Items 2).

3.4

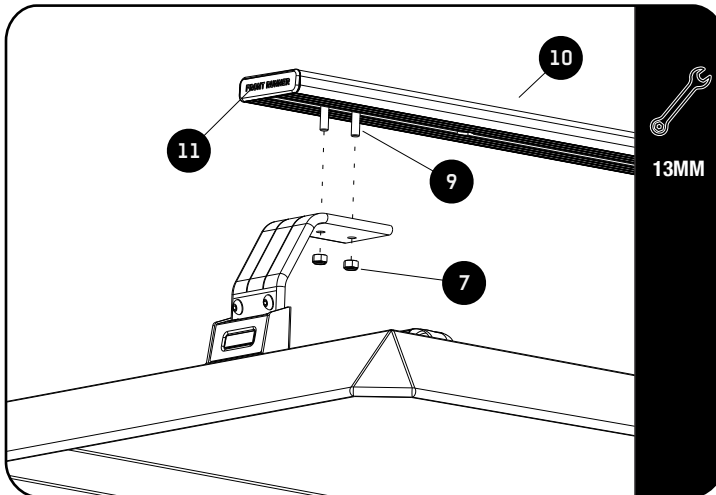

Loosely fit your Load Bar by using M8 x 25 Hex Bolts and M8 Nylocs (Items 7 & 9) as shown.

**⚠** The pre installed M8 nut in the end of the load bar should face down.

Insert the Slat End Cap (Item 11) into each end of the Load Bar.

3.5

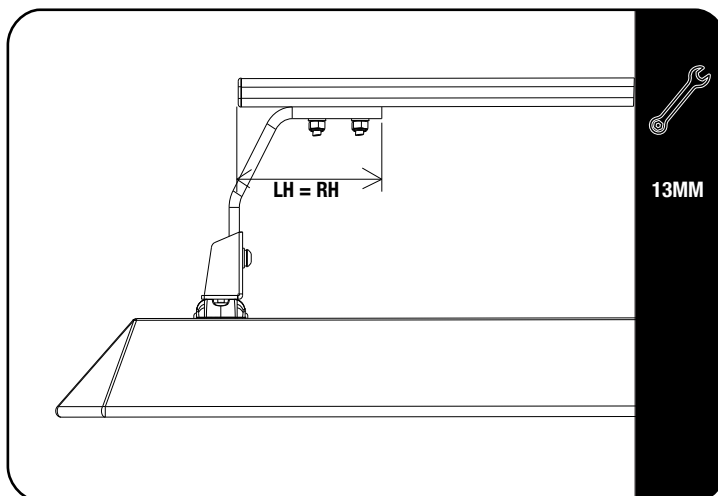

Center the Load Bar on the legs so that it is equal on both sides of the truck before fully tightening.

3

### FIT AND SECURE FEET AND LOAD BAR

3.6

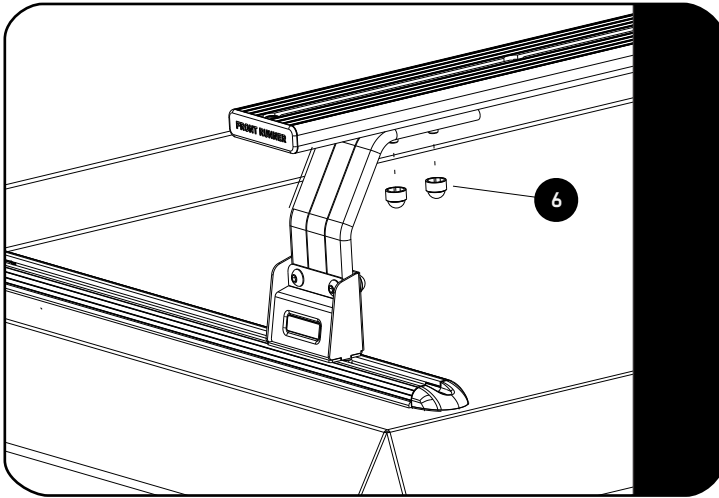

Place M8 Nut Caps (Item 6) on all nyloc nuts.

4

### COMPLETION

4.1

Congratulations! You did it. Take a step back and admire your work!



5

### INSTALL OTHER VEHICLE AND RACK ACCESSORIES

Now's the time to visit your favorite Front Runner Dealer in person or online.

### IMPORTANT!

FRONT RUNNER RACK KITS OFTEN HAVE A HIGHER LOAD RATING THAN THE VEHICLES THEY ARE MOUNTED TO. PLEASE REFER TO YOUR SPECIFIC VEHICLE MANUFACTURER FOR A RECOMMENDED ROOF RATING. FRONT RUNNER CANNOT BE RESPONSIBLE FOR IMPROPER LOADING BEYOND THE VEHICLE MANUFACTURER'S STATED LOAD CAPACITY.

Be sure to tag us. We love to see our gear in action! #FrontRunnerOutfitters

Share your adventures on:    

Lorem ipsum





# START HERE!

## READ ME FIRST

Don't be a hero and muscle through this installation without reading these fitting instructions first! Improper installation of this gear may void certain aspects of your warranty.

Before you begin, take a moment and open all your Front Runner rack kit boxes and gather the assembly instructions for the various components.

A complete kit will contain:

1. A Front Runner Track Kit
2. A Front Runner Load Bar Kit

This document will guide you through the assembly of the mounting system and assist you in fitting the roof rack tray or load bars to your specific vehicle.

Please refer to the next page for a list of all the components, quantities and tools required.

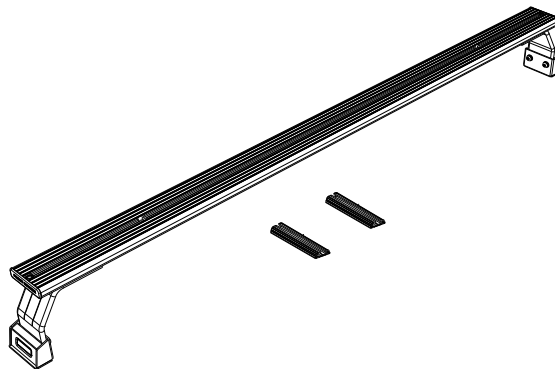

### IMPORTANT WARNING!

IT IS CRITICAL THAT ALL FRONT RUNNER PRODUCTS BE PROPERLY AND SECURELY ASSEMBLED AND ATTACHED TO YOUR VEHICLE. IMPROPER ATTACHMENT COULD RESULT IN AN AUTOMOBILE ACCIDENT, AND COULD CAUSE SERIOUS BODILY INJURY OR DEATH. YOU ARE RESPONSIBLE FOR ASSEMBLING AND SECURING ALL FRONT RUNNER PRODUCTS TO YOUR VEHICLE, CHECKING THE ATTACHMENTS PRIOR TO USE, AND PERIODICALLY INSPECTING THE PRODUCTS FOR ADJUSTMENT, WEAR AND DAMAGE. THEREFORE, YOU MUST READ AND UNDERSTAND ALL OF THE INSTRUCTIONS AND PRECAUTIONS SUPPLIED WITH YOUR FRONT RUNNER PRODUCT PRIOR TO INSTALLATION OR USE. IF YOU DO NOT UNDERSTAND ALL OF THE INSTRUCTIONS AND CAUTIONS, OR IF YOU HAVE NO MECHANICAL EXPERIENCE AND ARE NOT THOROUGHLY FAMILIAR WITH THE INSTALLATION PROCEDURES, YOU SHOULD HAVE THE PRODUCT INSTALLED BY A PROFESSIONAL INSTALLER OR OTHER QUALIFIED PERSONNEL.

**NOTE:** Front Runner will not be responsible for any damage caused by the failure to install the product according to these instructions.

Please call us if you have any questions about the installation of this product.

# 1 GET ORGANIZED - RACK

## IN THE BOX

1	4 X	M8 x 20 T-Bolt
2	2 X	Cover Plate
3	2 X	Leg Base
4	4 X	M8 x 25 Button Head
5	4 X	M8 x 19 x 2SS Flat Washer
6	8 X	M8 Nut Cap
7	12 X	M8 Nyloc Nut
8	2 X	Leg
9	4 X	M8 x 25 Hex Bolt
10	1 X	Slat - 1475mm Long
11	4 X	Slat End Cap
12	4 X	M6 x 30 Button Head Bolt
13	2 X	Track - 130mm Long
14	1 X	Track Rubber - 260mm Long
15	4 X	M6 x 19 x 1 SS Flat Washer
16	4 X	M6 Nyloc Nut

## TOOLS NEEDED

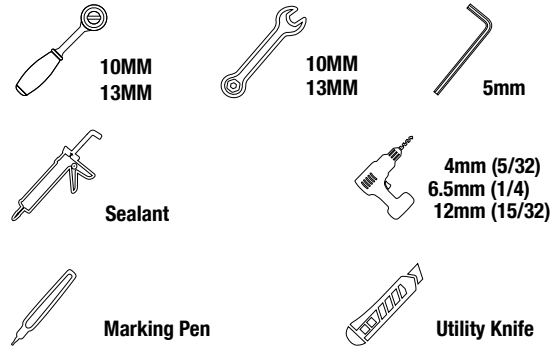
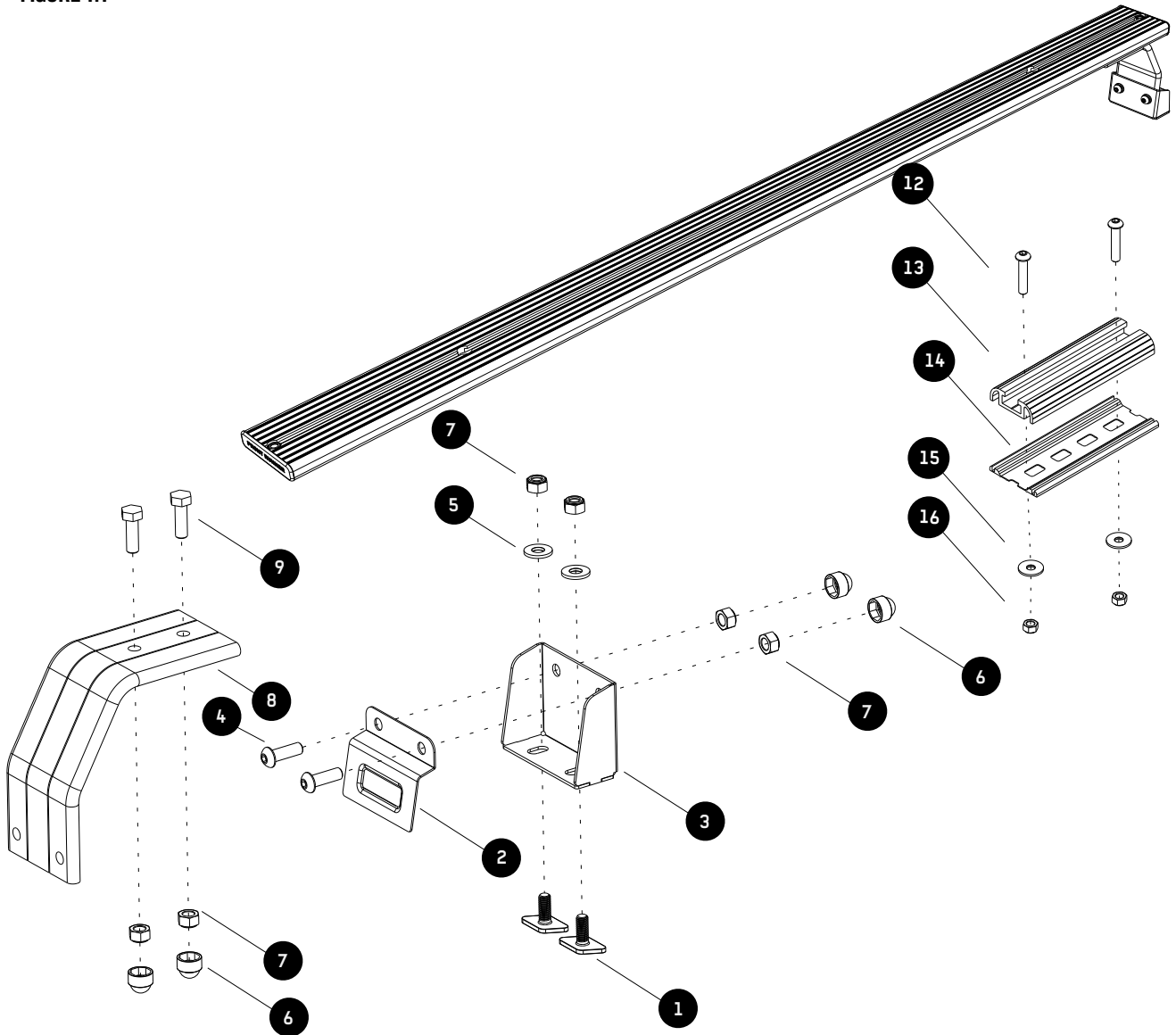

FIGURE 1.1



**2**

**FIT AND SECURE TRACKS**

2.1

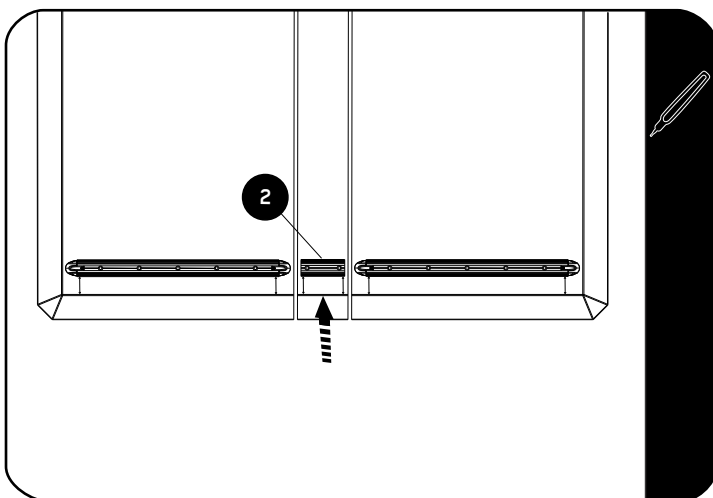

Align the short Tracks (Item 2) with your existing DiamondBack tracks.  
Mark the pre-drilled mounting holes in the track onto the cover.  
Double-check the underside of the cover to verify that nothing will obstruct the washers and bolts at these locations including the possibility of the drill bit hitting your bed rails.

2.2

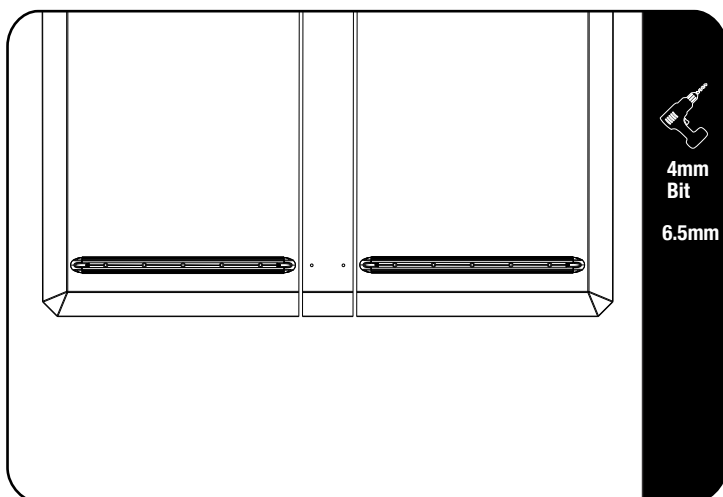

Remove the Tracks and drill a 4mm pilot hole on each of the marks you have made.  
Open the holes to 6.5mm.

2.3

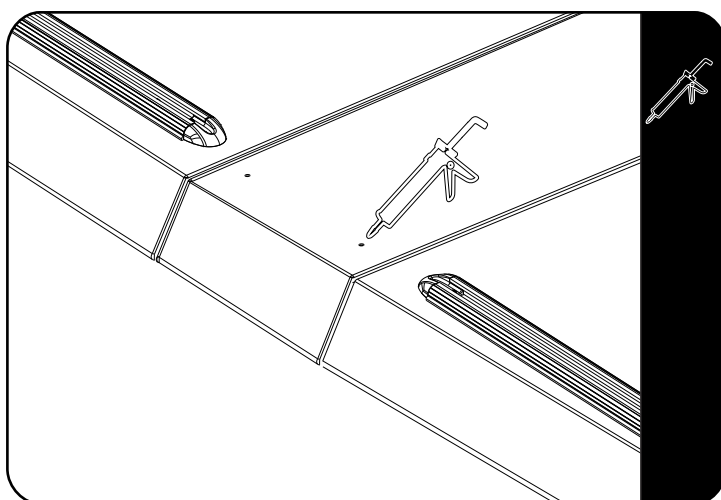

Before fitting the Tracks, place a small bead of sealant around each hole.

**2****FIT AND SECURE TRACKS**

2.4

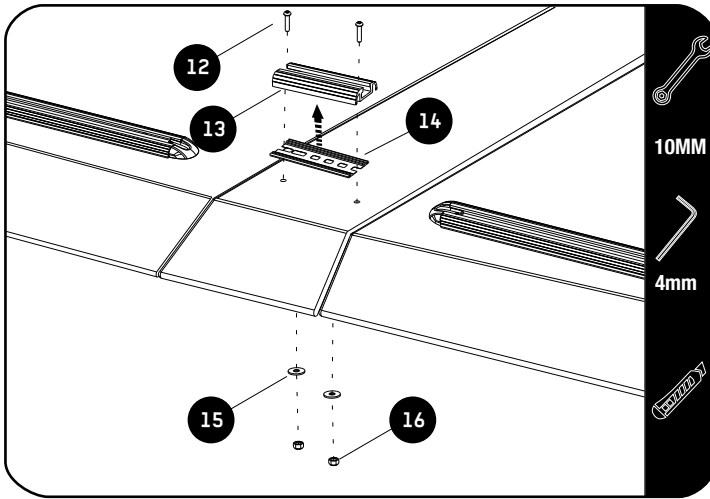

Before securing the tracks, remove the double sided tape from the bottom of the track.

Starting on one end, feed the Track Rubber (Item 14) onto the Track (Item 13).

Trim the Track Rubber to the correct length if needed.

Do this on both Tracks.

Secure the Tracks to the Cover using M6 x 30 Button Head Bolts, M6 x 19 x 1SS Flat Washers and M6 Nyloc Nuts (Items 12, 15 & 16) as shown.

2.5

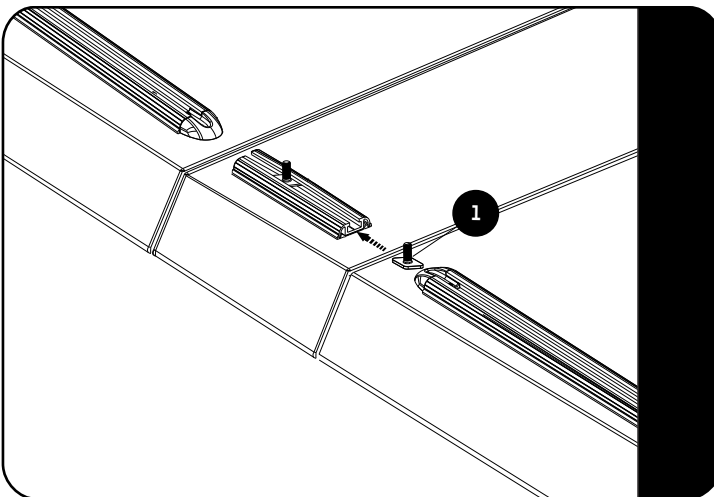

Slide the M8 T-Bolts (Item 1) into the Track T-slot as shown.

2.6

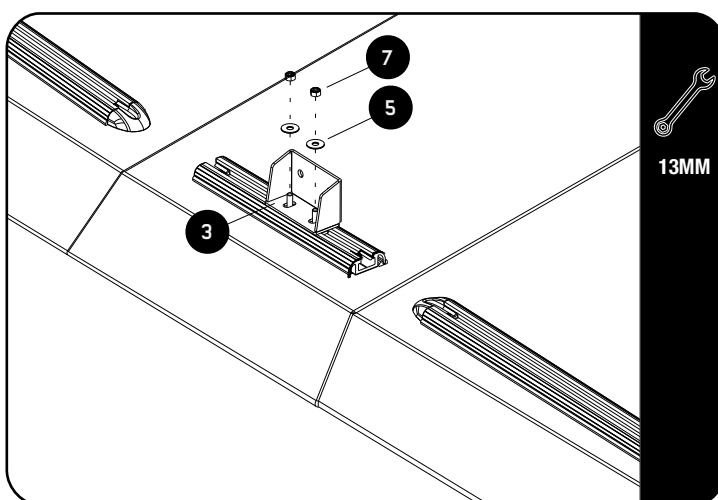

Loosely fit a Leg Base (Item 3) to the M8 T-Bolts using M8 x 19 x 2 Flat Washers and M8 Nyloc Nuts (Items 5 & 7).

2

## FIT AND SECURE FEET AND LOAD BAR

2.7

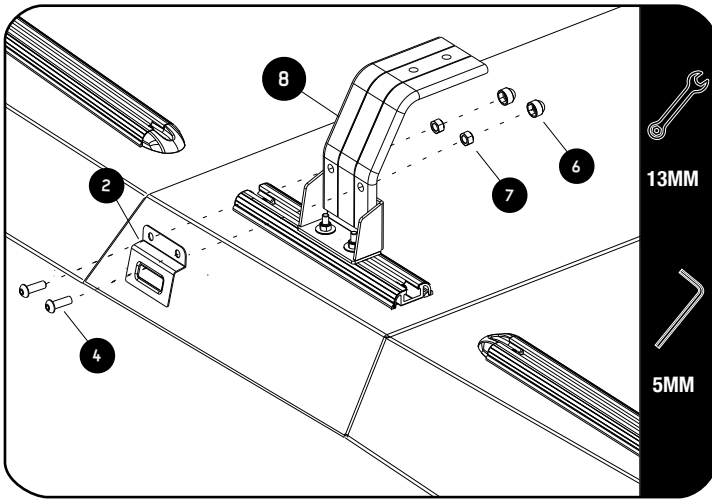

Assemble the Legs (Item 8) to the Leg Base (Item 3) by using M8 x 30 Button Heads & M8 Nyloc Nuts (Items 4 & 7) and the Cover Plate (Items 2).

2.8

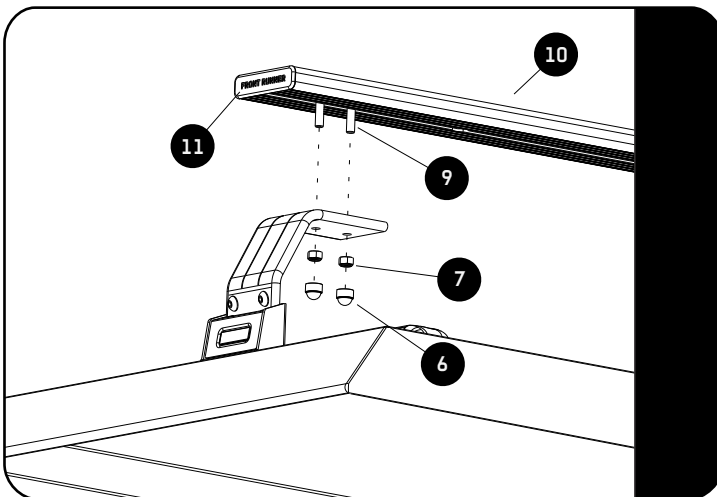

Loosely fit your Load Bar by using M8 x 25 Hex Bolts and M8 Nylocs (Items 7 & 9) as shown.

The pre installed M8 nut in the end of the load bar should face down.

Insert the Slat End Cap (Item 11) into each end of the Load Bar.

2.9

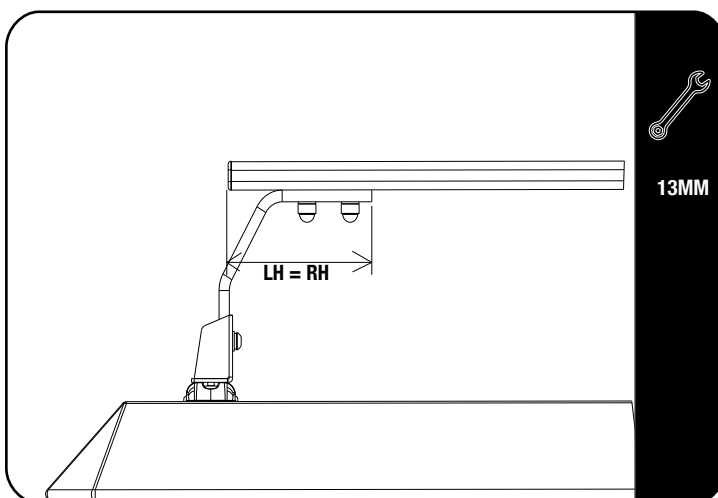

Center the Load Bar on the Legs before fully tightening (LH = RH).

3

## COMPLETION

3.1

Congratulations! You did it. Take a step back and admire your work!



4

## INSTALL OTHER VEHICLE AND RACK ACCESSORIES

Now's the time to visit your favorite Front Runner Dealer in person or online.

### IMPORTANT!

FRONT RUNNER RACK KITS OFTEN HAVE A HIGHER LOAD RATING THAN THE VEHICLES THEY ARE MOUNTED TO. PLEASE REFER TO YOUR SPECIFIC VEHICLE MANUFACTURER FOR A RECOMMENDED ROOF RATING. FRONT RUNNER CANNOT BE RESPONSIBLE FOR IMPROPER LOADING BEYOND THE VEHICLE MANUFACTURER'S STATED LOAD CAPACITY.

Be sure to tag us. We love to see our gear in action! #FrontRunnerOutfitters #BornToRoam

Share your adventures on: 