



**DIAMONDBACK**

DiamondBackCovers.com / 800 935 4002

**HINGES**

# REPLACEMENT GUIDE

**MISC-8**

**30 minutes**  
Normal install time

**Keep an eye out for these icons:**

**! IMPORTANT!**  
Important installation information

**★ Helpful Hints**  
Tips to assist installation

## PARTS INCLUDED:

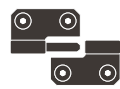

Slip Joint Hinges (2)

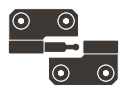

Locking Joint Hinges (2)



Black Button Head Bolts (16)



5/16" Lock Nuts (16)



5/16" Washers (16)



Marker



Pry Tool (Optional)



Ratchet Wrench



1/2" Socket



3/16" Hex Key

## PRE-INSTALLATION NOTE:

It's possible for one person to upgrade the hinges solo, but it's much easier if you have two people.

## INSTRUCTIONS

- Remove the tail panel by detaching its gas springs, tilting it past 90° and begin to unmate the hinges. Depending on the date that your cover was produced, your hinge type may be different than your replacement hinges.

First Hinge Type A

Second Hinge Type A

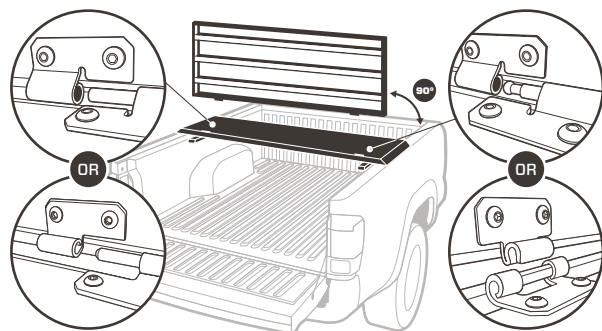

First Hinge Type B

Second Hinge Type B

- The existing holes are intentionally oversized. Before removing the current hinges, use a marker to make a small hash mark indicating the correct bolt and washer alignment on the underside of the cover at all hinge bolt locations.

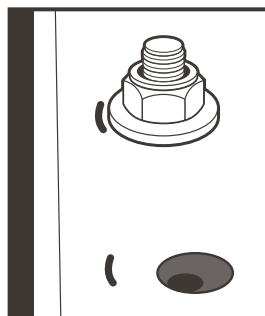

- Use a 3/16" hex key and a ratchet wrench with a 1/2" socket to remove the tail-panel hinge leaves.

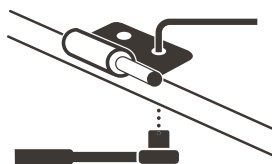

- Remove the corresponding stationary-panel hinge leaves.

- On the driver side of the panel, align the new slip joint hinge parallel to the panel edge using the existing bolt holes and accompanying hashmarks made previously. Secure it with two bolts, two washers, and two lock nuts. Use the 3/16" hex key and a 1/2" socket to fully tighten. Repeat this process for the passenger-side hinge.

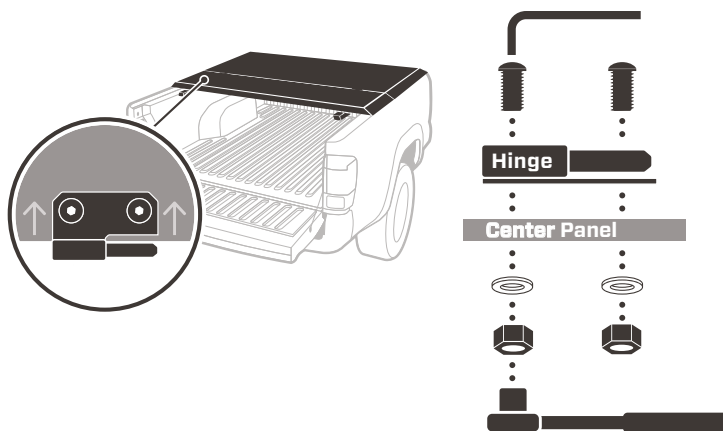

- Repeat steps 1-6 for the remaining panel(s).

**!** Be sure to reinstall the safety tethers and safety catch in their original location per your cover's included installation guide.

**★** If you have a DiamondBack 270 or DiamondBack 180, you may need to remove the whole cover from the truck in order to have enough clearance to remove the panels.